

Eastport II Bedroom Collection

Distressed Honey Finish

Assembly Instructions



Model #

4504AFDH

Eastport II

1-Drawer Nightstand



Model #

4519AFDH

Eastport II

4-Drawer Chest



Model #

4520AFDH

Eastport II

5-Drawer Chest



Model #

4564AFDH

Eastport II

9-Drawer Dresser

Congratulations!

This fine piece of furniture will make a handsome addition to your home. For the best results, start by reading the Assembly Instructions before you begin your project.

**For normal household use only.
NOT recommended for commercial use.**



Do not climb, sit or stand on this piece of furniture.

Unload items from this unit prior to moving.

Before loading or moving this unit, check all screws and supports for tightness.

For maximum stability, attach unit to the wall using the enclosed hardware as per instructions.

DESIGN SUBJECT TO CHANGE WITHOUT NOTICE.

**Whittier
Wood**
FURNITURE

P.O. Box 2827
Eugene, OR 97402 USA



CALL US FIRST!

DO NOT RETURN ITEM TO STORE

Service Policy: We will replace parts which are defective, missing or damaged. Please contact Whittier Wood Products customer service department directly (by phone, fax, mail or E-mail) for replacement parts.

Hours: Our friendly customer service staff can be reached Monday-Friday 7:00 a.m. to 5:00 p.m. (Pacific Time). A message can be left 24 hours a day, 7 days a week.

To Order: Provide the complete furniture model number, part letter, production code, quantity needed, reason for replacement and your full name and address along with a telephone number in case we need to contact you.

Parts ship from our Eugene, Oregon factory within 1 or 2 business days from the time we receive the request. Please allow 5-10 business days for delivery.

800-653-3336

Outside U.S. or Canada: 541-687-0213

Fax: 541-687-2060 • www.whittierwood.com

Mail: P.O. Box 2827 • Eugene, Oregon 97402, U.S.A

IMPORTANT NOTES:

- Store the item: 1) in the box; 2) in a dry place; 3) in temperatures ranging from 40° to 90°. (Not on a cold, possibly damp, cement floor.)
- Inspect your furniture periodically for any loose glue joints or screws, or any other problem which may be affecting the stability of your furniture. Tighten or repair as needed.

Production Code:

VN

10/08

4504AFDH, 4519AFDH, 4520AFDH, 4564AFDH Eastport II Bedroom Collection – Parts List

Please identify the parts and check that quantities received match those on this list.

If you need to replace a part, refer to the following letter and model name.

Part	Description	Model #	Model #	Model #	Model #
		4504AFDH	4519AFDH	4520AFDH	4564AFDH
		Qty.	Qty.	Qty.	Qty.
A	Top Assembly	1	1	1	1
B	Case	1	1	1	1
C	Drawer Box*	1	4	5	0
D	Small Drawer Box*	0	0	0	3
E	Large Drawer Box*	0	0	0	6
F	Drawer Face	1	0	0	0
G	Upper Drawer Face	0	1	1	3
H	Lower Drawer Face	0	3	4	6
L	Knob	1	8	10	9
M	Nylon Restraint Strap	1	1	1	2
N	Clip	2	2	2	4
O	#8 x 2" Black Screw	2	2	2	4
P	#8 x 1" Pan Screw	2	2	2	4
Q	4 x 30 mm Machine Screw	1	8	10	9
R	Drawer Slides (pre-installed sets)	1	4	5	9

*Does not include the Drawer Face

4504AFDH shown in the drawings below.



A – Top Assembly



B – Case



C, D or E Drawer Box

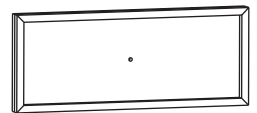

F, G or H Drawer Face



L – Knob



M – Nylon Restraint Strap

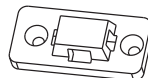

N – Clip



O – #8x2" Black Screw



P – #8x1" Pan Screw



Q – 4x30mm Machine Screw

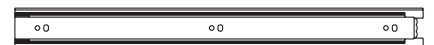

R – Drawer Slides (pre-installed sets)

4504AFDH, 4519AFDH, 4520AFDH, 4564AFDH Eastport II Bedroom Collection Assembly Instructions

TOOL REQUIRED:

Phillips Screwdriver

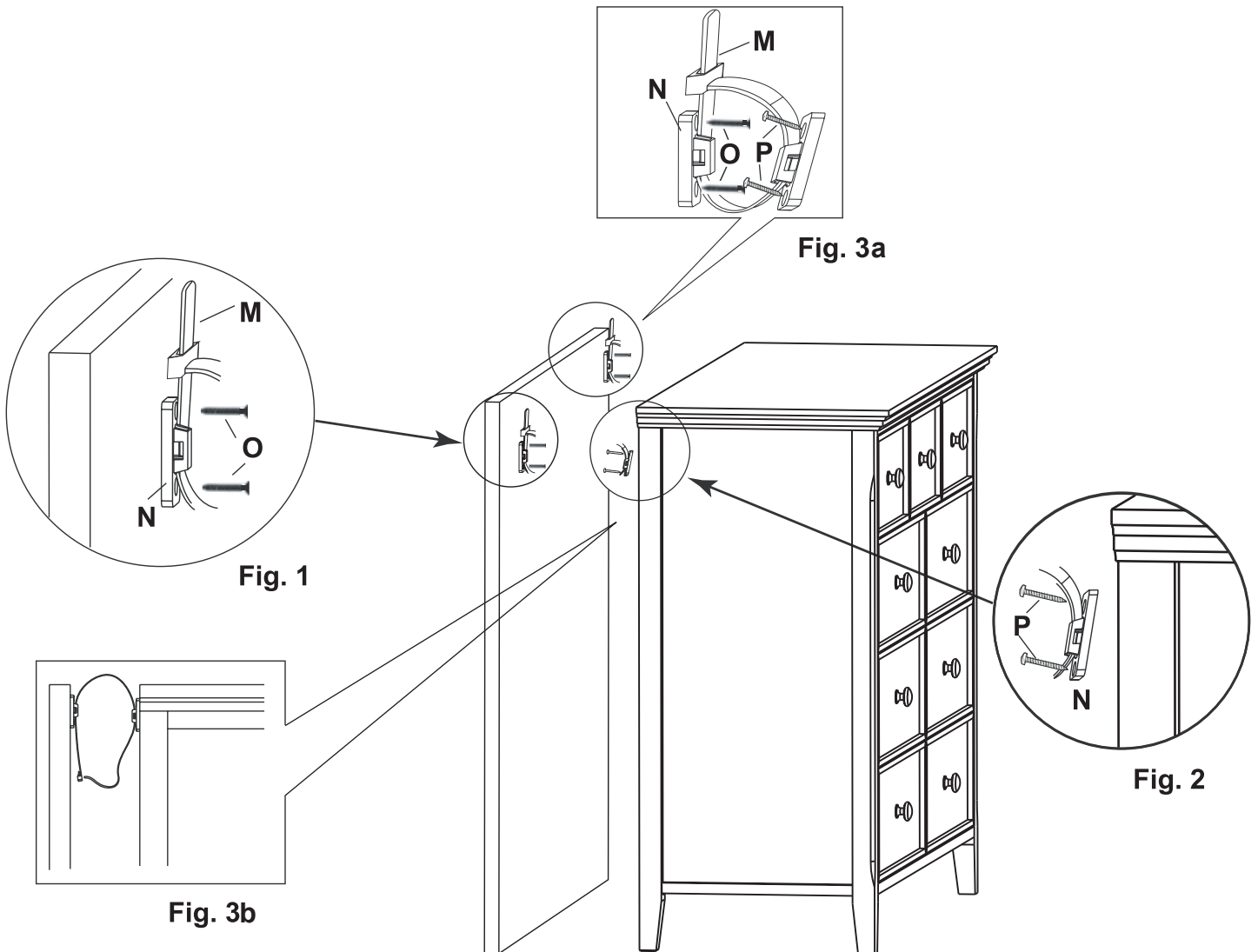

4564AFDH shown in above drawing.

TIPPING RESTRAINT

1. Position unit at desired location. Locate stud in the wall behind unit. Attach Clip (N) to wall stud with two #8 x 2" Black Screws (O). See Figure 1. Attach second clip to unit with two #8 x 1" Pan Head Screws (P). See Figure 2. Connect the two clips with Nylon Restraint Strap (M). See Figures 3a and 3b. **NOTE: 4564AFDH requires two tipping restraints.**

If you can't locate a stud, purchase proper wall attachment hardware for your type of wall and secure the unit.